



Smart Music Control Application

User Guide

CONTENTS

CONTENTS	1	Car Receiver Mode Main Screen	5
GETTING STARTED	1	Status Indicator	5
How to Install Smart Music Control App	1	Source Name Screen	5
Preparing the Music Player	1	Source Info Bar	6
MEDIA PLAYER MODE	1	Media Information Panel	6
Media Player Screen	1	Play Time Bar	6
Category Selection Screens	1	OPERATION FEATURES	7
Current List Screen	2	Gesture Control	7
Mood Blender Screen	2	Gesture Commands in Operation	8
Making a Playlist	3	VOICE COMMAND	8
Adding Songs to a Playlist	3	SMS READER	9
Equalizer Screen	3	Enable SMS Reader	9
Mood Playlist	4	Enable SMS Blacklist	9
Song Background Analysis	4	OTHER PREFERENCE SETTING	9
Play a song from Mood Category Screen	4	Preference Setting	9
CAR RECEIVER MODE	5		
Entering into Car Receiver Mode	5		

GETTING STARTED

JVC Smart Music Control App requires the following for proper operation:

- Android OS 2.2 and above
- Bluetooth support.

The system requirement information as mentioned above is not a guarantee that the application will work on all Bluetooth® compatible devices.

How to Install Smart Music Control App

JVC Smart Music Control is a free application, available in the Google Play Store. This app enhances the user experience of compatible JVC car receivers. Search for “JVC Smart Music” in Google Play Store to locate and download the Smart Music Control App into your device. Alternatively, you can scan the QR code using your android device below to directly access the Smart Music Control App in the Android Play Store.



Preparing the Music Player

Copy music files into the internal storage or the SD card of your device.

Note

If music files are stored in the SD card, do not remove or dismount the SD card while playing songs.

Supported audio files

- MP3 (.mp3)
- AAC-LC/TLP (.m4a, aac)
- PCM/WAVE (.wav)
- Ogg Vorbis (.ogg)
- AMR-NB (.3gp)
- AMR-WB (.3gp)

MEDIA PLAYER MODE

Media Player Mode playback songs saved in the device.

Media Player Screen

1. Tap once on the Media Player screen to play the song.

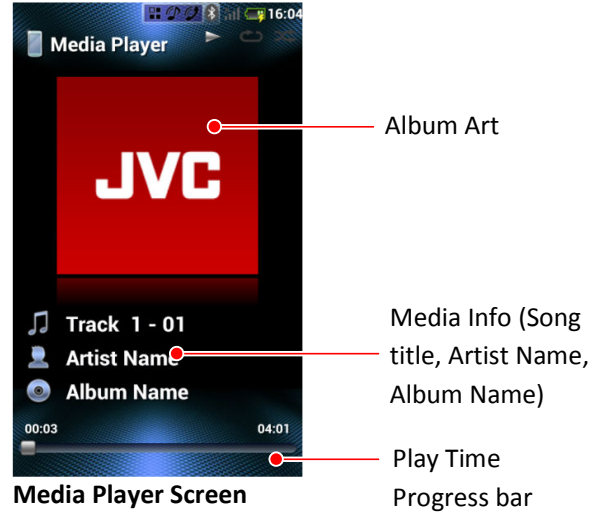

2. You can control the song playback as follows:
 - To pause or resume playback, tap once on the screen.
 - To skip to the previous song, swipe left.
 - To skip to the next song, swipe right.
 - To repeat all songs or one song, curve right.
 - To play songs at random, curve left.

(Refer to page 7 for Gesture Controls)

Category Selection Screens

Songs in your device are automatically sorted into different categories for easy song selection. This list of screens displays the songs in their respective categories.

1. Go to “Menu > Content List” or Swipe up to open the Category Selection screen.

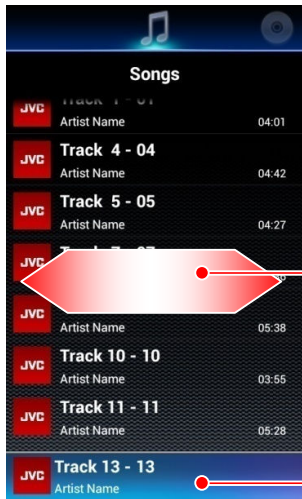

List Screen

Flick left or right to go to a different category screen.

Currently playing song
Touch to change to Media Player screen

The available categories are: Songs, Albums, Artists, Playlist and Mood.

2. Swipe Left/Right to change categories, and tap on an item to select it. The item hierarchies are listed below:



>Songs



>Album > Song



> Artist >Albums > Song



> Playlists*1 > Song



>Moods*2 > Mood in detail > Song

*1 To play a song in Playlists, create playlist and add your favorite songs. -> See **PLAYLIST** (page 3)

*2 To play a song in Moods, Mood Analysis must be performed in advance. -> See **MOOD PLAYLIST** (page 4).

To return to the Media Player Screen, tap the currently playing song or tap the return key on your device.

Current List Screen

Based on the category used to select the currently playing song, the lineup of all the songs in that chosen category is displayed in the Current List Screen.

1. Swipe down the Media Player screen to open Current List screen.



Current List Screen

Currently playing song

2. Tap a song to play.

To return to the Media Player screen, tap return key on your device.

Mood Blender Screen

The Mood Blender Screen is a special display screen that displays an active visualization*1 during song playback, and the pre-analyzed songs can be selected by using the Mood Selector.

1. Perform a 2-finger swipe left/right on the Media Player Screen to open the Mood Blender screen.

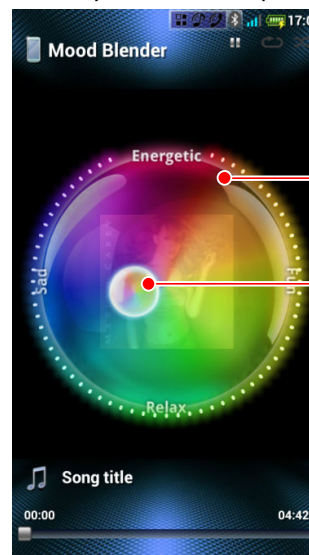

Mood Blender Screen

Mood Matrix Area

Mood Selector
Move it to adjust the current mood

2. Tap and drag the Mood selector circle to your preferred mood in mood matrix area to adjust the current mood.

Note

To use the Mood Blender function, you first need to analyze all songs using the Song Background analysis function. (Page 4)

To return to the Media Player screen, perform a 2-finger swipe left/right on the Mood Blender screen.

*1 Visualization is only available for devices with Android 2.3 and above.

Making a Playlist

Playlists enables a custom selection of songs for continuous playback based on the individual preference.

1. In the Category Selection Screen, swipe to the Playlist category.
2. Select "Add New Playlist"
3. Enter a new name for this playlist and select OK.

Adding Songs to a Playlist

Songs can be added to the playlist in "Current List Screen" and "Category Selection Screen > Songs".

1. While in any of the 2 screens, long press on a song item.
2. An "Add to Playlist" dialog screen will pop up. Select the appropriate playlist to add the selected song to.

Equalizer Screen

Select Preset Equalizer

1. Tap the Menu on your device.
2. Tap [Equalizer] in menu list.
3. Select Preset Equalizer Flat/Dynamic/Natural/Vocal Boost/Bass Boost.

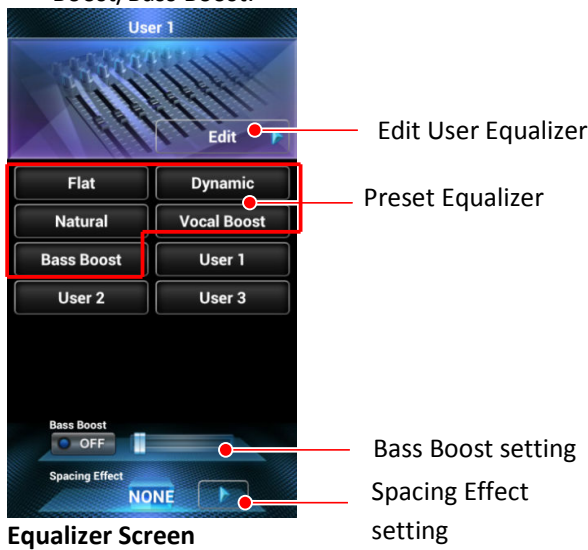

Note

Equalizer settings only work in Media Player Mode. When the App is connected to a JVC Car Receiver and enters Car Receiver Mode (Page 5), this Equalizer function will be disabled.

Edit User Equalizer

1. Tap **User 1/ User 2/ User 3**.
2. Tap **Edit**.
3. Change the level of each band.
4. Tap **Save**.

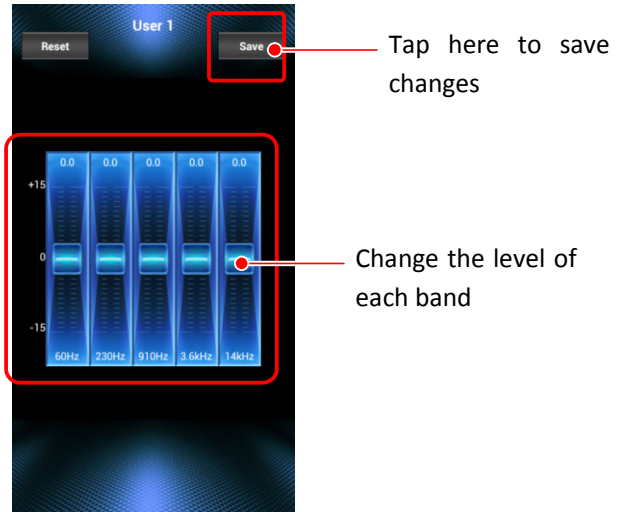

User Equalizer Screen

To return to the Media Player Screen, tap the return key on your device.

Bass Boost setting

1. Tap **Bass Boost** to ON.
2. Move the slide bar to adjust the Bass Boost level.

Spacing Effect setting

1. Tap **Spacing Effect**.
2. Choose your preferred effect from the pop up list.

Note

Equalizer function is only available for devices with Android 2.3 and above.

Mood Playlist

JVC Smart Music Control analyzes the mood of songs using its Mood Analyzer Function. Once analysis is complete, songs are classified into the following 13 moods. The songs classified are added in [🎨 Moods] automatically and you can enjoy songs by selecting the individual mood.

Mood	Description
Acoustic: Gentle music comprising relatively weak tones	
Detailed	Piano solo, quiet classical music, etc.
Simple	Folk music, music playing with a few instruments
Smooth	Mature jazz
Easy	Slow ballad
Standard: Music with a feeling of rhythm	
Dynamic	Big-beat jazz playing by a big band
Rockin	Classic Rock
Vivid	Rock or Pop music with a good beat
Stylistic: Techno-pop or music playing with electronic instruments	
Cool	Ambient Techno
Urban	Dance, Bossa nova
Trance	Trance, Drum'n'Bass
High: EnergyEnergetic and Loud	
Active	Rap, Hip-hop
Powerful	Hard Rock
Core	Punk, Metal
Unclassifiable	Song that cannot be classified or analyzed

Note

The song cannot be analyzed if its time is shorter than 20 seconds.

Song Background Analysis

Analyze all songs

1. Tap the Menu button on your device.
2. Tap [⚙️ Preference].
3. Check [Manual Song Mood Analysis].



All songs are analyzed while songs are playing. After analysis is completed, the songs will be classified and added in [🎨 Moods] automatically.

The current progress of Song Mood Analysis can be found in the Android Notification Panel in the Android Home Screen.

Note

If the remaining battery capacity of your device falls below 20%, the background analysis will be stopped, in order to conserve battery.

To cancel song analysis while analyzing all songs

1. Exit the application by pressing HOME on the device.
2. Pull down the Android Notification Panel.
3. Tap  to display the song analysis status.
4. Tap [ Analyzing ...(song name)].
5. Tap the Menu button on your device.
6. Tap [ Cancel analysis] and then [OK].

Play a song from Mood Category Screen

1. In the Category Selection Screen, swipe left/right to  moods category.
2. Tap Mood > Mood in detail > Song.

CAR RECEIVER MODE

Car Receiver Mode allows communication with a nearby JVC Receiver, and functions such as sending remote control commands, receiving data and other useful information from the receiver can be performed.

Entering into Car Receiver Mode

In order to make use of the Car Receiver Mode function, the android device must first be paired with a compatible BT-enabled JVC Car Receiver present within 10m of the Android device. (Visit the JVC website [\[Link Here\]](#) for device compatibility)

1. Perform a Bluetooth pairing between the Android device and the JVC Car Receiver.
2. Once pairing is successful, launch JVC Smart Music Control App on the Android device.
3. Go to "Menu > Connect" to initiate a connection between the app and the receiver.
4. Select the JVC receiver that was paired earlier in the dialog box that pops up.
5. Wait for further instructions to appear on the app screen.
6. The app is now connected to the receiver, and the app enters Car Receiver Mode.

Car Receiver Mode Main Screen

The following sections provide a detailed description of items displayed while using Smart Music Control App in Car Receiver Mode.

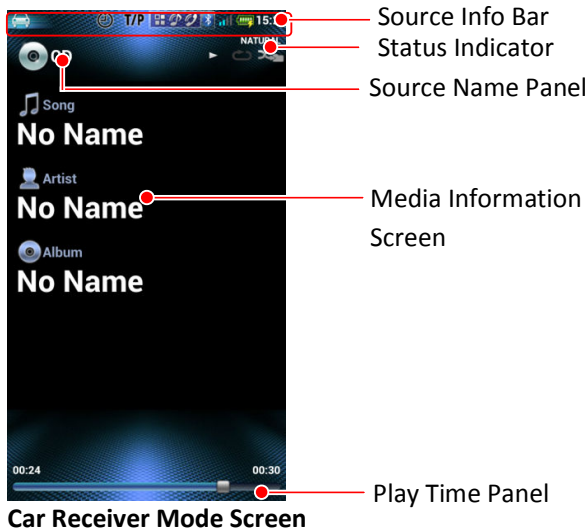

Status Indicator

The status area shows the connectivity status for various Bluetooth functions, and status of traffic program, radio timer in car receiver.

Functions	On	Off
Bluetooth		
Bluetooth Hands-free connection		
Bluetooth Audio connection (A2DP*)		
JVC Applink connection		
T/P (Traffic Program)		
Radio Timer		

* Advanced Audio Distribution Profile (A2DP)

Source Name Screen

The source name panel shows the currently selected source in the connected JVC car receiver.

The following table is the list of the source.

Icon	Source
	USB
	SD
	iPod Mode
	iPod Head Mode
	iPod App Mode
	CD
	Tuner
	HD Radio *1
	Bluetooth Audio
	Aux-In
	Unknown *2





*1 Available for HD Radio Ready car receiver models only

*2 Smart Music Control App does not support Satellite Radio, EXT IN and BT Pandora.



Source Info Bar

The source info bar shows the playback status.

Repeat Indicator

Icon	Repeat Type
	Repeat Off
	Repeat Once
	Repeat Folder/ Group
	Repeat All

Random Indicator

Icon	Random Type
	Random Off
	Random Folder/Group
	Random All

Play/Pause Indicator



Play/Pause indicator shows the current playback status.

Mute Indicator



Mute indicator shows the volume status of the receiver (Mute On/Off).

Mute indicator is available for sources which do not support play/pause operations, except Bluetooth Audio source.

Stereo/Mono Indicator

Stereo/Mono icon is available only in Tuner source. If Stereo/Mono icon does not appear, the current station does not have available Stereo/Mono information.

HD Radio Indicator

HD Radio indicator shows availability of HD radio in the current frequency. "HD" flashes when the car receiver is searching for a HD channel. "HD" lights up when the car receiver finds a HD channel. "HD" goes off when the car receiver is unable to find any HD channel in the current frequency.

EQ Indicator

The EQ icon shows the selected EQ setting of the current source in the car receiver. Refer to the JVC car receiver user manual for more details on supported EQ.

Media Information Panel

The media information panel displays some information of a song or a radio station. For example, when the car receiver plays MP3 song with ID3 tag, the song title, artist name and album name are displayed.

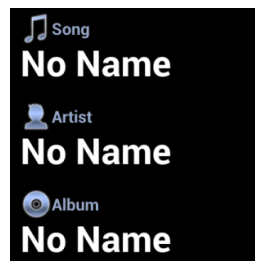

When playing a song

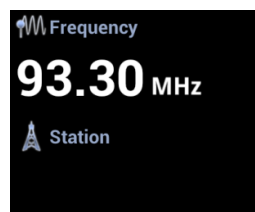

When listening to the radio

Play Time Bar



Play Time Bar is only available for sources that support play time indication, which include sources like CD-DA and Music Files in USB mass storage.

OPERATION FEATURES

Gesture Control

Gesture control operation is designed for quick operation control without looking at the smart phone.

Refer to JVC Smart Music Control App internal help (“menu->preference->help”) for more details.

All gesture control patterns in JVC Smart Music Control App are showed in the figure below.

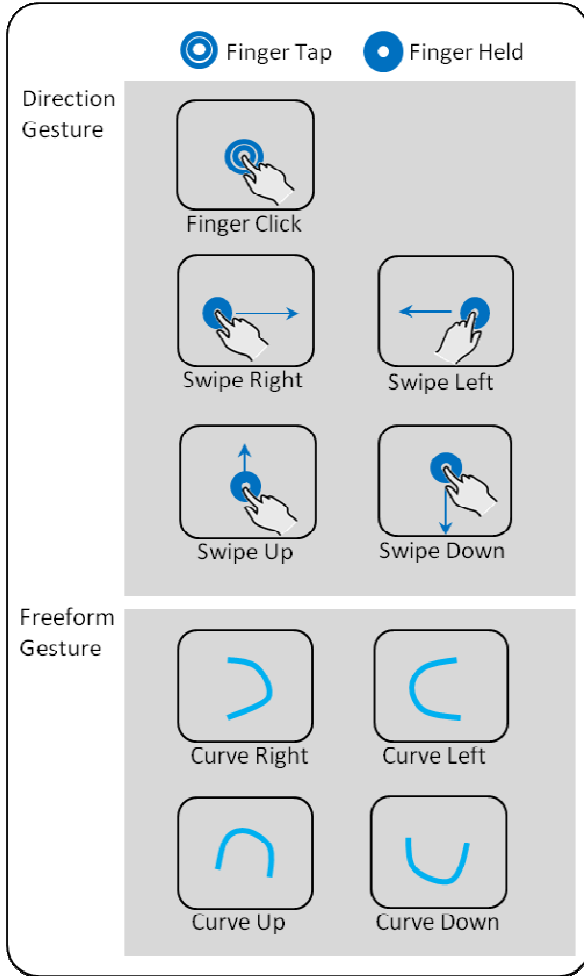

Note

For freeform gestures, these gestures can be initiated from any direction as long as the final drawn shape is similar to the gestures in the chart.

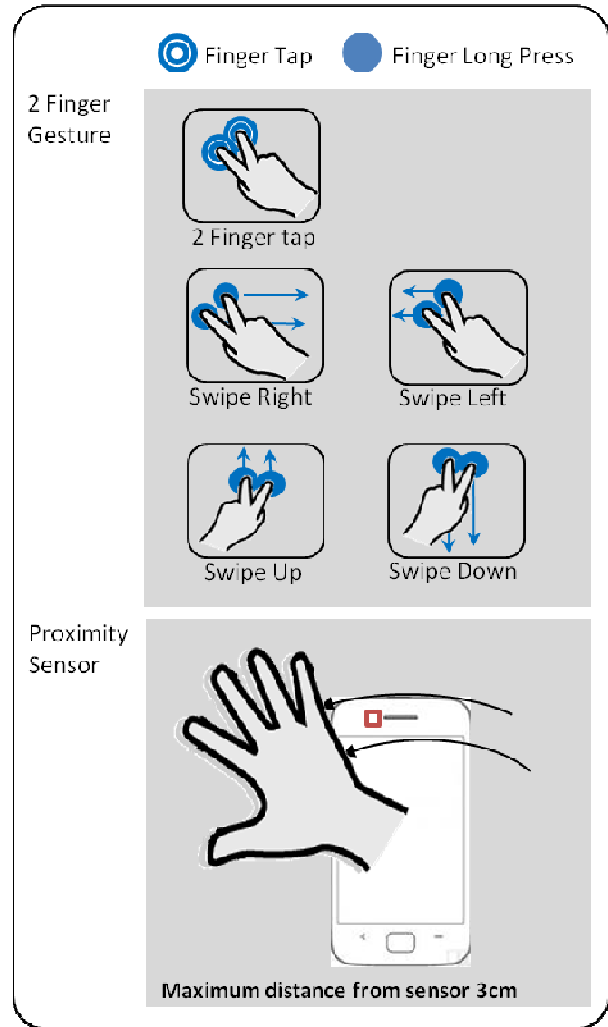

Note

To enable proximity sensor, turn on the proximity sensor in the preference setting.

Gesture Commands in Operation

The same gesture controls performed in different sources will trigger different operations. The mapping of each gesture control to each source is listed in the table below.

Gesture	Car Receiver Mode*	Media Player Mode
Direction Gesture		
Finger Click	Play/Pause/ Mute	Play/Pause
Long Click	Voice command	Voice command
Swipe Right	Next Song/Right Auto Scan	Next Track
Swipe Left	Previous Song/Left Auto Scan	Previous Track
Swipe Up	Folder Up/Group Up/Up Preset	Load Content List UI
Swipe Down	Folder Down/Group Down/Down Preset	Load Current Playlist UI
Freeform Gesture		
Curve Right	Random Toggle/HD UI*2	Random Toggle
Curve Left	Repeat Toggle/HD UI*2	Repeat Toggle
Curve Up	Source Change	None
Curve Down	EQ Toggle	Toggle Preset EQ
Multi Point Gesture		
2 Finger Swipe Up	Volume UP	None
2 Finger Swipe Down	Volume Down	None
2 Finger Swipe Left	Load Mood Selection	Load Mood Selection*1
2 Finger Swipe Right	Load Mood Selection	Load Mood Selection*1
Other Sensor		
Proximity sensor	Voice Command	Voice Command

Note

*1 In Bluetooth Audio source, control functionality is phone dependant.

*2 HD AM/FM supports display of TEXT information of current streamed music.

VOICE COMMAND

JVC Smart Music Control App accepts voice command to control playback and music search. Besides the playback control, voice command can also control other actions while in Car Receiver mode (e.g. change source, tune preset).

Before you start voice command, choose your preferred voice recognition engine language in “Voice music search language” located in the preference setting.

To trigger voice command, perform a 2 finger tap or the proximity sensor gesture. Wait for “ready tone” before speaking your command.

Voice Command	Car Receiver Mode	Media Player Mode
Playback Control Command		
Play Next	⊙	○
Play previous	⊙	○
Repeat off	⊙	○
Repeat all	⊙	○
Repeat track	⊙	○
Repeat group	⊙	X
Shuffle off	⊙	○
Shuffle all	⊙	○
Shuffle group	⊙	○
Show Mood blender	○*BT Only	○
Music Search Command		
Music Search song	○*BT Only	○
Music Search artist	○*BT Only	○
Music Search album	○*BT Only	○
Car Receiver Mode Command		
Change Source to CD	○	X
Change source to SD	○	X
change Source to USB	○	X
Change Source to Bluetooth	○	X
Change Source to Auxiliary	○	X
Change Source to iPod	○	X
Change Source to iPhone	○	X
Tune to FM	○	X
Tune to Am	○	X
Seek Up	○*Tuner Only	X
Seek Down	○*Tuner Only	X
Preset 1	○*Tuner Only	X
Preset 2	○*Tuner Only	X
Preset 3	○*Tuner Only	X
Preset 4	○*Tuner Only	X
Preset 5	○*Tuner Only	X
Preset 6	○*Tuner Only	X

X Not Support, ○ Full Support, ⊙ Partial Support

Note

The Voice recognition engine requires internet access to process voice data.

SMS READER

The SMS reader function in JVC Smart Music Control App reads out incoming SMS messages. It makes use of the Android Text-to-Speech engine to read out the SMS message.

Enable SMS Reader

1. Tap the Menu button on your device.
2. Tap [Preference].
3. Tap [SMS Reader].
Option list appears.
4. Choose your reference option.

Note

In order to read out SMS messages, the Android Text-to-Speech engine first requires a download of voice data information in your preferred language.

Enable SMS Blacklist

1. Tap the Menu button on your device.
2. Tap [Preference].
3. Check [Enable SMS Blacklist].
4. Tap [SMS Read Blacklist].
SMS blacklist screen appears.

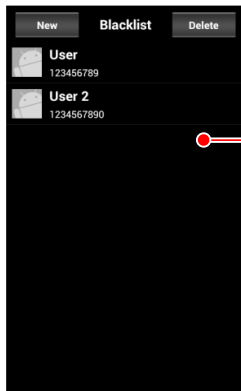

SMS Blacklist screen

5. Add contact into blacklist.

OTHER PREFERENCE SETTING

Preference Setting

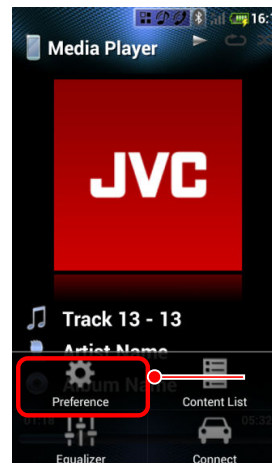

Preference setting

Menu Screen

Other preference settings can be accessed by pressing the MENU key on the device. Descriptions for various options are provided in the preferences setting screen itself.